

VARISEAL[®]

STUFFING BOX

Assembly and operating instructions



The installation

The SPW VARISEAL stuffing box is delivered pre-assembled and ready for installation. Make sure that the hose (inside) and the stern tube (outside) are free of grease during installation.

To install the stuffing box, the shaft in the coupling must be loosened and pulled.

Put the stuffing box then carefully, without damaging the radial shaft seal, over the shaft and with the rubber hose over the stern tube, then tighten the heavy duty hose clamps securely.

A few turns should be made on the cap of the grease can to fill the grease chamber of the stuffing box with EP/SAL special grease.

Depending on the size of the SPW stuffing box, it may be necessary to re-fill the stuffing box with EP/SAL special grease.

Alternatively, a spindle grease gun or hand lever grease gun with a hose can be installed (optional special accessory). The spindle grease gun or hand lever grease gun can be installed in a locker or in the engine room, for example.

Re-assemble the shaft and the coupling.



Your SPW VARISEAL stuffing box is now ready for use.

Also, before entering the water, take care that all heavy-duty hose clamps stopper and locknuts are tightened!

Attention:

The initial operating temperature of the stuffing box after installation can reach +70°(160 F) to +90°C (195 F). Do not touch the stuffing box, there is a risk of burns.

The EP/SAL special grease, as well as all necessary spare parts, are available at SPW-GmbH.

During operation

After longer trips under engine, the VARISEAL stuffing box should be re-greased approx. every 40-50 operating hours.

The normal operating temperature of the SPW stuffing box is after a longer running-in period is approx. 40°C (105 F).

If grease or water leaks from the tamper, proceed as follows:

Grease:

If grease leaks from the stuffing box, it is a sign of over greasing, remove the excess grease and do not re-grease.

Water:

If water leaks from the stuffing box, this is a sign of grease deficiency.

Re-grease the stuffing box sufficiently with EP/SAL special grease.

Loosen the lock nut of the stuffing box and turn the tamper approx. 5 mm clockwise into the stuffing box.

Then secure the lock nut again.



If water is still leaking, repeat this procedure.

The change of the gland packing

A complete change of the gland packing every 2-3 seasons is optimal, but it is also possible to replace the gland packing in the stuffing box during the season when the boat is in the water.

Complete change of the gland packing:

If the complete gland packing is to be changed, the yacht **must be in the drydock** (winter storage, shipyard, etc.).

Loosen the lock nut counterclockwise and turn the tamper out of the stuffing box.

Remove the worn gland packing and cut the new one to length.

Press 2-3 gland packings, that the joint is offset by 180°, into the stuffing box.



Screw the lock nut completely onto the tamper and screw the tamper back into the stuffing box until a slight resistance is achieved. Now secure the tamper to the stuffing box again with the lock nut.

If water or grease leaks out during the test run, readjust the stuffing box as described in the section In operation on page 3.

Replace the gland packing:

If the gland packing is to be refitted, the boat can stay in the water. Loosen the lock nut counterclockwise and turn it out of the stuffing box with the tamper.

Do not remove the old gland packing but cut the new one to length. Press 1-2 new gland packings into the stuffing box so that the joint is offset by 180° as shown in the pictures on page 4.

Screw the lock nut completely onto the tamper and screw the tamper back into the stuffing box until a slight resistance is achieved. Now secure the tamper to the stuffing box again with the lock nut.

If water or grease leaks out during the test run, readjust the stuffing box as described in the section "In operation" on page 3.

Changing the radial shaft seal

If the radial shaft seal is to be replaced, the yacht **must be in the drydock**. (winter storage, shipyard, etc.).

To remove the stuffing box, the shaft in the coupling must be loosened and pulled out.

Loosen the heavy-duty hose clamps on the stuffing box and remove it from the sterntube and pull it off the shaft. We recommend carefully clamping the stuffing box in a vice.



Remove the circlip with a circlip pliers



Remove the circlip with a slotted screwdriver

Clean the radial shaft seal seat in the stuffing box and insert the new radial shaft seal correctly in place.



wrong



correct

Carefully press the shaft seal into the stuffing box with a mandrel (Fig.) into the stuffing box as far as it will go.



Put the circlip back into the stuffing box with circlip pliers.



Make sure that the circlip is correctly seated.

Parts list

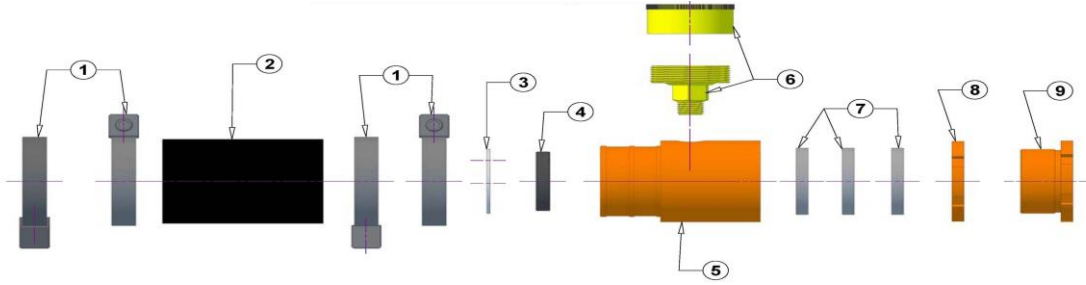

1. 4x heavy duty hose clamps (may look different due to construction)
2. 1x fabric hose
3. 1x circlip
4. 1x radial shaft seal (may be omitted due to construction)
5. 1x VARISEAL grease chamber
6. 1x Staufer tin
7. 3x gland packing (can be more or less depending on construction)
8. 1x counter nut
9. 1x lock stuffer nut

Special accessories (not included in the scope of delivery)

Grease gun



Spindle grease gun



High-pressure hose



Hook wrenches



Screw fitting

